



PG...

JOINT PROTECTOR

Suitable for protecting the mid-span joint while passing on pulley-blocks during conductor stringing operations.

Upon placing the purchase order, please specify:

L = joint length after compression

D = conductor diameter

CH = hexagonal key (joint section dimension after compression)

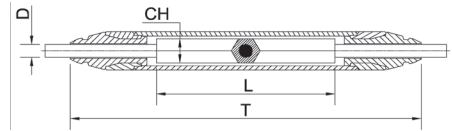

RUBBER ENDS (interchangeable)

Mod. PG 60/R....

Mod. PG 80/R....

Mod. PG 90/R....

Upon placing the purchase order, please specify conductor overall diameter.



MODEL	Pulley's groove width	Max hexagonal key	Breaking load
	mm	mm	kN
PG 60	68	40	20
PG 80	95	56	20
PG 90	95	65	20

654/...

RATCHET TYPE CONDUCTOR CUTTER

MODEL	Suitable for cutting of:	Max cutting capacity	Length	Weight	Spare blades
		mm	mm	kg	
654/1	ACSR, AAC, AAAC, copper cond.	31	740	5	654/3
654/2	Steel wire	11	711	4	654/4



655/...

HAND OPERATED HYDRAULIC CONDUCTOR CUTTER

MODEL	Max cutting capacity		Length	Weight	Spare blades
	Steel wire / earth wire	Bare conductor (*)	mm	kg	
655/1	13	24	370	2,7	655/1L
655/2A	18	45	550	7	655/2L

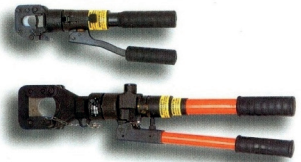

NOTE: (*) ACSR-AAC-AAAC and copper;

- Supplied with case.

TR01

ACSR CABLE TRIMMER

For a fast and accurate cable trimming.

Standard set composed of: 1 cutter, 1 bush-support, 3 bushes and 1 plastic transport case.

NOTE: Upon placing the purchase order, please specify conductor overall diameter.

