

UNDERGROUND CABLE LAYING ACCESSORIES

500/AL

STRAIGHT ROLLER

Aluminum roller for laying straight cables.
Mounted on ball-bearings and galvanized steel frame.
Weight 5 kg.

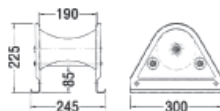

500/AC

STRAIGHT ROLLER

Galvanized steel roller for laying straight cables.
Mounted on ball bearings and galvanized steel frame.
Weight 3,5 kg.

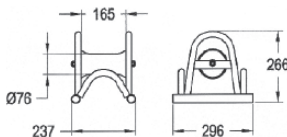

503/AL

CORNER ROLLER

Aluminum rollers for laying cables in curves.
Mounted on ball-bearings and galvanized steel frame.
With hinges for laying several elements in curves.
Weight 14 kg.

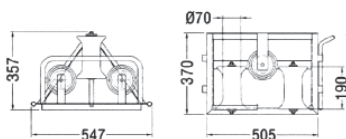

503/AC

CORNER ROLLER

Steel rollers for laying cables in curves.
Mounted on ball-bearings and galvanized steel frame.
With hinges for laying several elements in curves.
Weight 10 kg.

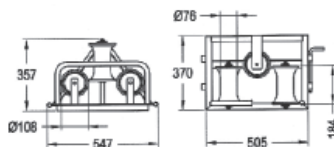

609

CORNER ROLLER

Steel rollers for laying cables in curves.
Mounted on ball-bearings and galvanized steel frame.
Oscillating vertical rollers.
With hinges for laying several elements in curves.
Weight 17 kg.

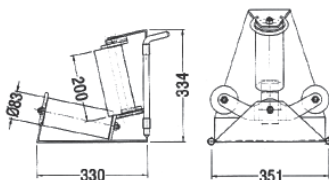



608/...

CABLE DUCT ENTRANCE DEVICE

In galvanized steel with 4 rollers arranged as a frame and a half sleeve, for cable installation in ducts.



MODEL	For duct internal diameter	Weight
	Ø mm	kg
608/1 (*)	60	3,4
608/2	80	3,8
608/3	100	4,6
608/4	120	5
608/5	140	6
608/6	160	6,5
608/7	180	7
608/8	200	8

608/... C

CABLE DUCT ENTRANCE DEVICE

In galvanized steel with 4 rollers arranged as a frame and completely openable sleeve, for cable installation in ducts.



MODEL	For duct internal diameter	Weight
	Ø mm	kg
608/1 C (*)	60	4
608/2 C	80	4,4
608/3 C	100	5,5
608/4 C	120	6
608/5 C	140	6,8
608/6 C	160	7,5
608/7 C	180	8,5
608/8 C	200	9,8

508/AL

CABLE DUCT ENTRANCE DEVICE

In galvanized steel with aluminium roller mounted on ball-bearings, and completely openable sleeve, for cable installation in ducts.



MODEL	For duct internal diameter	Weight
	Ø mm	kg
508/AL 1 (*)	60	4
508/AL 2	80	4,5
508/AL 3	100	5
508/AL 4	120	6
508/AL 5	140	7
508/AL 6	160	7,5
508/AL 7	180	8,8
508/AL 8	200	10

601/AL

MANHOLE ENTRANCE ROLLER

Aluminum roller on ball-bearings, mounted on galvanized steel frame, suitable for manhole cable entrance.
Weight 6,5 kg.

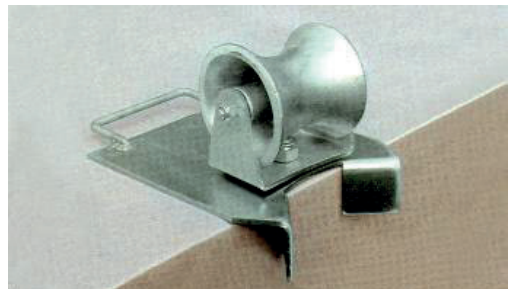
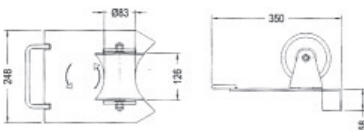

UNDERGROUND CABLE LAYING ACCESSORIES

605/AL...

MANHOLE ENTRANCE ROLLER

Aluminum rollers on ball-bearings, mounted on galvanized steel frame, suitable for manhole cable entrance.

Weight 12 kg.

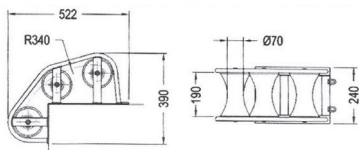

505/...

CABLE GUIDING AND RUN-OFF FRAME

Steel guiding rollers on ball-bearings, mounted on galvanized steel frame, suitable during cable pay-out.

MODEL	Capacity daN	A mm	B mm	C mm	D mm	Weight kg
505	200	35	1000	500	500	12
505/R	500	60	1000	700	565	22

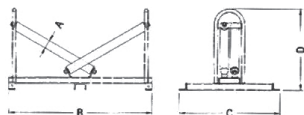

603 AL... - 604 AL...

MANHOLE ENTRANCE ROLLER

Aluminum rollers on ball-bearings, mounted on galvanized steel frame, suitable for manhole cable entrance.

Interchangeable sleeve in galvanized steel with fixing flanges.

MODEL	For duct internal diameter	B	C	D	E	F	Weight
	mm	mm	Ø mm	mm	mm	mm	kg
603 AL/1	80	126	83	505	500	340	18
603 AL/2	100	126	83	505	500	340	18,5
603 AL/3	120	126	83	505	500	340	19
604 AL/4	140	126	83	505	500	340	20

MODEL	For duct internal diameter	B	C	D	E	F	Weight
	mm	mm	Ø mm	mm	mm	mm	kg
604 AL/1	80	126	83	900	550	840	24
604 AL/2	100	126	83	900	550	840	24,5
604 AL/3	120	126	83	900	550	840	25
604 AL/4	140	126	83	900	550	840	26

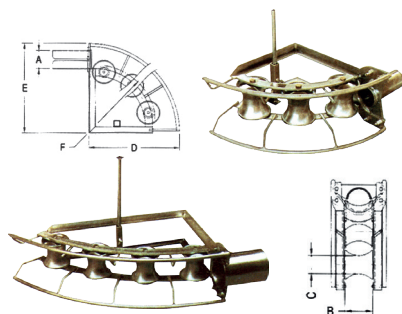

Mod. B...

INTERCHANGEABLE SLEEVE IN GALVANIZED STEEL WITH FIXING FLANGES FOR 603 AL AND 604 AL

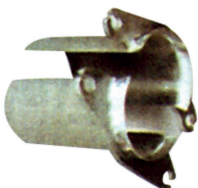

MODEL	For duct internal diameter
	mm
B1	80
B2	100
B3	120
B4	140



607AL...

MANHOLE ENTRANCE GUIDING DEVICE

Suitable for cable laying at the manhole entrance with deviations or height differences.

Aluminum rollers on ball-bearings, mounted on galvanized steel frame with telescopic rod for adjustment.

MODEL	For duct internal diameter (A)	B	C	D	E	F	Weight
	mm	mm	Ø mm	mm	mm	min-max mm	kg
607 AL/1	80	190	83	350	370	1200-2100	24
607 AL/2	100	190	83	350	370	1200-2100	26
607 AL/3	120	190	83	350	370	1200-2100	28
607 AL/4	150	190	83	350	370	1200-2100	30

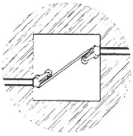

Deviation

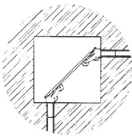

Deviation

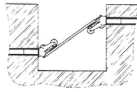

Difference in height

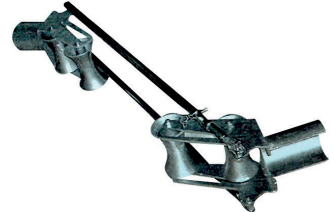
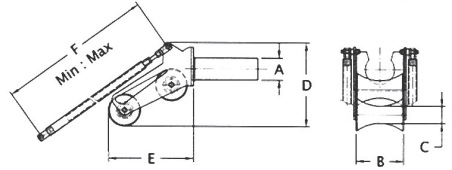

700

CABLE PROTECTING BEND

Galvanized steel protection curve for ducts with an internal diameter of 100 mm.
Weight 1,3 kg



701

CABLE PROTECTING BEND

Galvanized steel protection curve with arresting fin for ducts with an internal diameter of 100 mm.
Weight 1,3 kg



506

CABLE PROTECTING BEND

Galvanized steel protection curve with corner support in for manhole cable entrance.
Weight 1,6 kg



UNDERGROUND CABLE LAYING ACCESSORIES

507

CABLE PROTECTING SLEEVE

Galvanized steel protecting sleeve with fixing screws.
Composed of two easily openable parts.

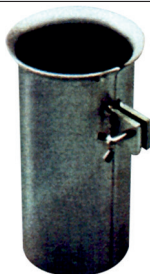

MODEL	Ø	Weight
	mm	kg
507/1	80	1,7
507/2	100	2
507/3	120	2,5
507/4	140	2,8

SOM 6...

FIBERGLASS DUCT ROD

Fiberglass duct rod supplied with starting/ending threaded ends and starting spinner with pulling eyelet. Wound on steel reel and mounted on steel frame for horizontal use.

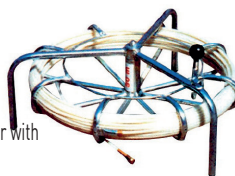

MODEL	Length	Rod	Frame	Weight
	m	Ø mm	Ø mm	kg
SOM 6.30	30	6	550	5,8
SOM 6.50	50	6	550	6,8
SOM 6.60	60	6	550	7,3
SOM 6.80	80	6	550	8,4

SOM V 6...

FIBERGLASS DUCT ROD

Fiberglass duct rod supplied with starting/ending threaded ends and starting spinner with pulling eyelet.
Wound on steel reel and mounted on steel frame for vertical use.

MODEL	Length	Rod	Frame	Weight
	m	Ø mm	Ø mm	kg
SOM V 6.30	30	6	550	6,8
SOM V 6.50	50	6	550	7,8
SOM V 6.60	60	6	550	8,3
SOM V 6.80	80	6	550	9,4

SOM 9... SOM 11...

FIBERGLASS DUCT ROD

Fiberglass duct rod supplied with starting/ending threaded ends and starting spinner with pulling eyelet. Wound on steel reel and mounted on steel frame for vertical use, complete with rubber wheels for easy displacement.



MODEL	Length	Rod	Frame	Weight
	m	Ø mm	Ø mm	kg
SOM 9.60	60	9	700	20
SOM 9.80	80	9	700	22
SOM 9.100	100	9	1000	24
SOM 9.120	120	9	1000	25
SOM 9.150	150	9	1000	28
SOM 11.100	100	11	1000	35
SOM 11.120	120	11	1000	38
SOM 11.150	150	11	1000	43
SOM 11.200	200	11	1000	50
SOM 11.250	250	11	1000	58
SOM 11.300	300	11	1000	66

Fiberglass spare rod **Mod. SOM Ø/F**

Available on request: Mod. SOM R...

Fiberglass rod with copper core.